

EASY REPLACEMENT
No Tools Means No Tools!



PIONEER[®] REDOX FILTRATION

The PIONEER[®] REDOX cartridge is a twin cartridge based E3 Cartridge Tank[™] filtration solution for the removal of Iron, Manganese, and Hydrogen Sulfide, without a backwashing control valve and no wasted water to drain. The system operates in a lead-lag configuration, with the oxidation of contaminants happening in the first housing and the capture of the oxidized agents in the second.

The first PIONEER[®] REDOX cartridge features ENPRESS' exclusive ATOMUS[®] O26 filtration media working in up-flow service and oxidizing contaminants, and then is directly followed by an E3 system containing a proprietary and specially formulated 5-micron filter that captures the oxidized particles. The system requires a short start-up procedure and then provides continuous contaminant removal. Without the requirement of additional oxidizing agents or backwashing.

Maintenance of the system is simple, with the removal, washing, and/or replacement of the post-filtration cartridge. No drain. No backwashing. No waste. Applications show efficacy for iron removal from 5 ppm and higher and service flow rates up to 7 gpm (26.5 LPM).

USED IN A LEAD-LAG SYSTEM

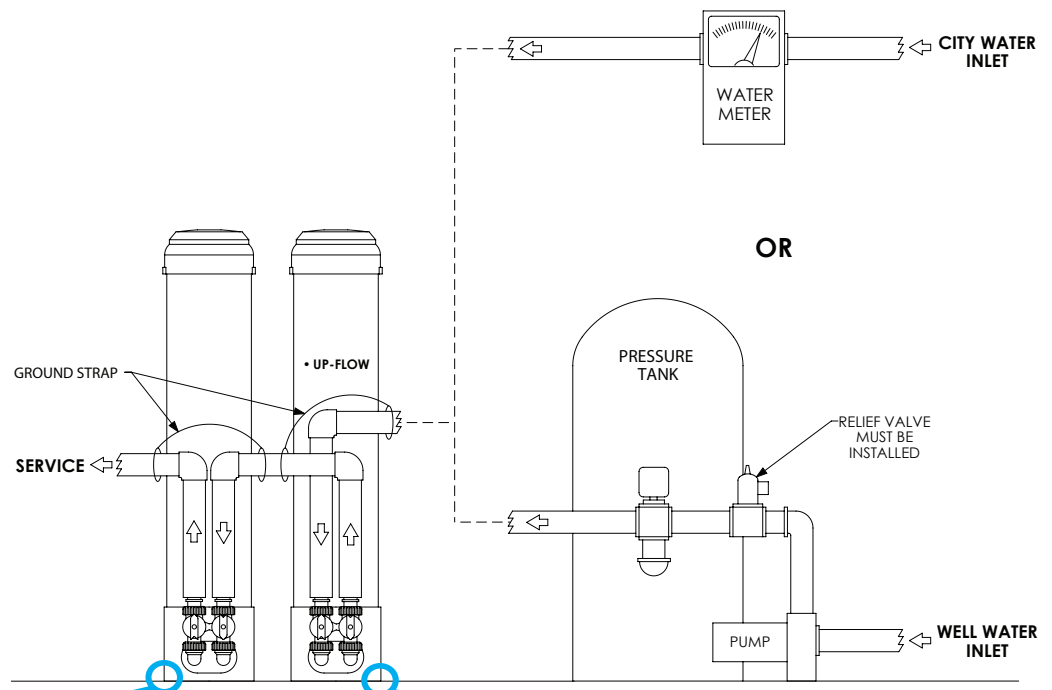

PIONEER[®] REDOX
Post-Filter Cartridge

CT-05-REDOX26:
5-Micron Pleated and Proprietary
Core Cartridge. LAG. For use with E3
Cartridge Tank[®] System.

PIONEER[®] REDOX Oxidizing Cartridge
with ATOMUS[®] O26 Inside

CT-MEDIA05-REDOX26:
Iron, Manganese, Sulfur Oxidation
Cartridge. LAG. For use with E3
Cartridge Tank[®] System.

TECHNICAL SCHEMATICS

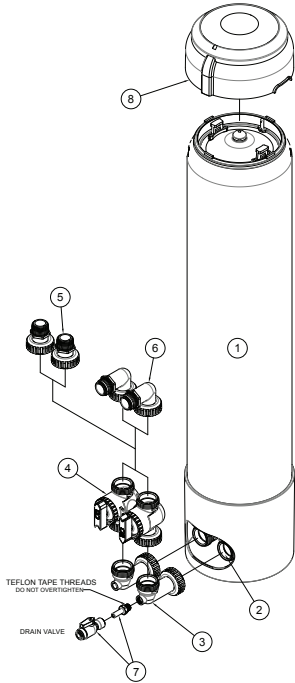

PART IDENTIFICATION

1. ONE-E3 Filtration System / Housing
2. In/Out Head for 1.050" Riser Pipe
3. 90 Degree Vertical Elbow With/without Machined Drain Port
4. Bypass Manifold
5. 1" MNPT Straight Connector
6. 1" MNPT 90 Degree Elbow Connector
7. 3/8" PEX Drain Valve Kit Assembly With Shut-off
8. PCB Umbrella Without Electronics

E3 FILTRATION SYSTEM

INTEGRATED BYPASS, METER & DRAIN CONNECTION SYSTEM



The E3 connection system is available to use with all POE (point-of-entry) filters in the blue, green, yellow, orange, silver and white filtration series.

EASY REPLACEMENTS

NO TOOLS REQUIRED

1. PRESS THE RED PRESSURE RELIEF VALVE TO UNSEAT THE RING



2. REMOVE SNAP RING



3. LIFT TOP CAP



SPECIFICATIONS

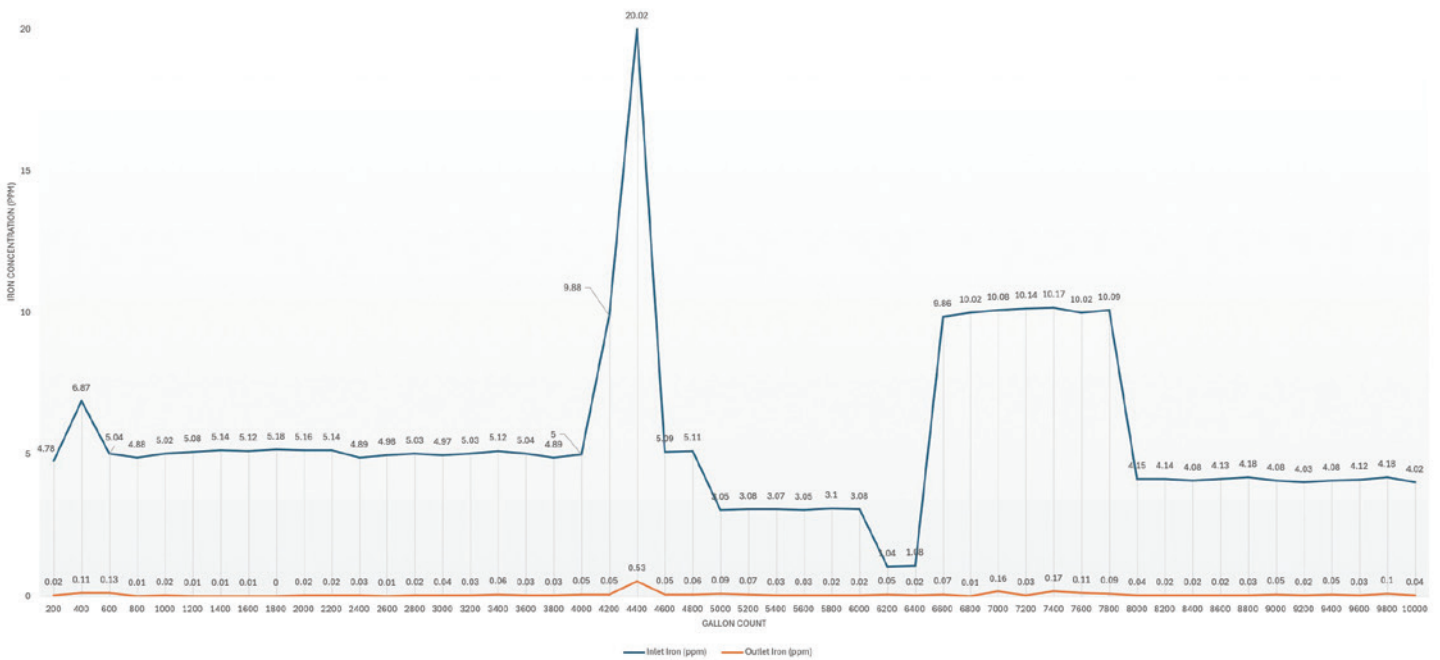

ENPRESS®, ONE®, CARTRIDGE TANK®, E3®, AND UMBRELLA CAP® are trademarks of ENPRESS, LLC. US and International patents, and patent pending.

Performance claims are based on independent lab results and manufacturer's internal test data. Actual performance is dependent on influent water quality, flow rates, system design and applications. Your results may vary. Micron ratings based on 85% or greater removal of a given particle size. Flush new cartridges until water runs clear prior to use. Do not use with water that is microbiologically unsafe or of unknown quality without adequate disinfection before or after the system.

For more information, visit enpress.com or onefiltration.com

ENPRESS, LLC. // 34899 Curtis Blvd., Eastlake Ohio 44095 // Phone: 866.859.9274 // Fax: 440.510.0202 // info@enpress.com